

Prospetto tipologia T1

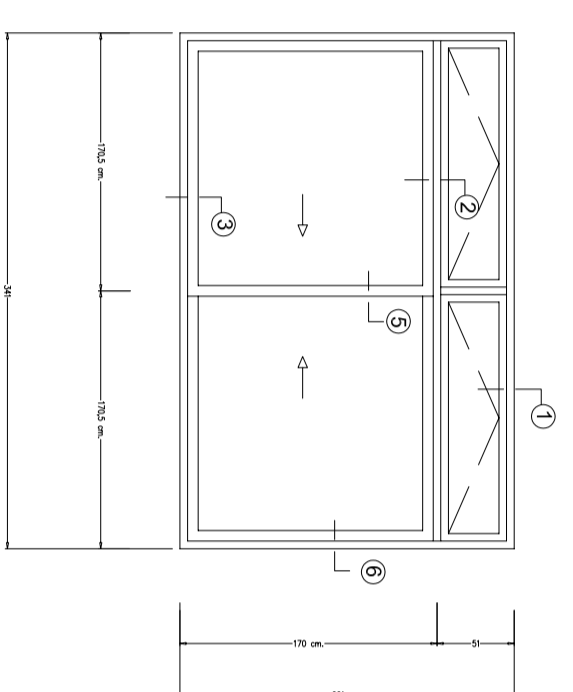

1 SEZIONE VERTICALE
Pannello a vista laterale

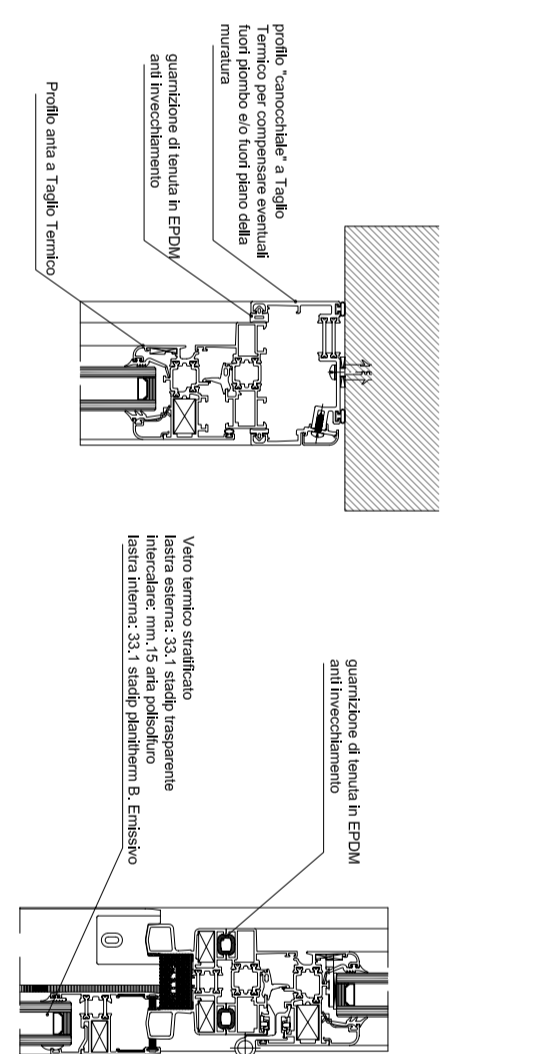

2 SEZIONE VERTICALE
Pannello tipo "trasvolante"

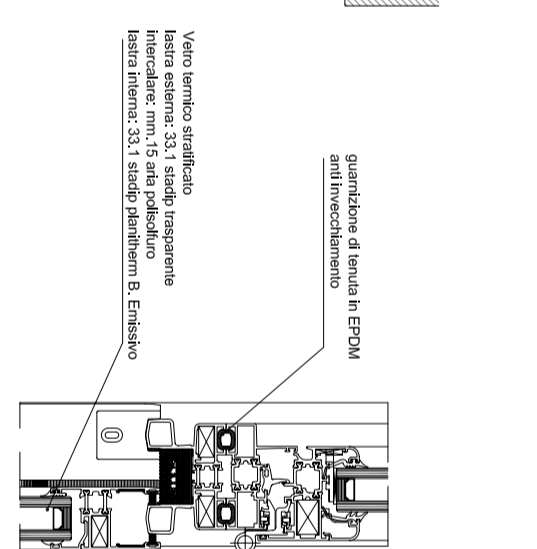

3 SEZIONE VERTICALE
Pannello a vista frontale

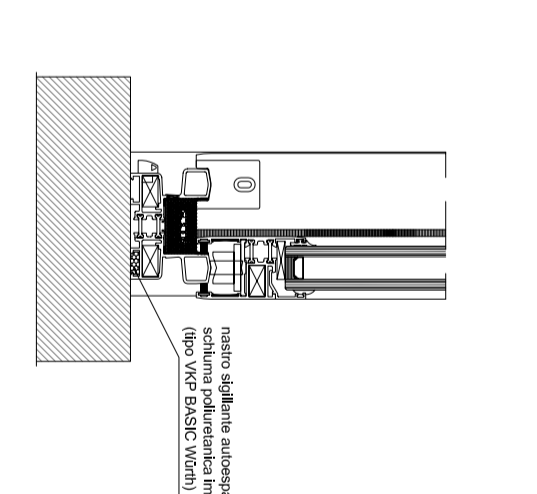

5 SEZIONE ORIZZONTALE
Pannello tipo "trasvolante"

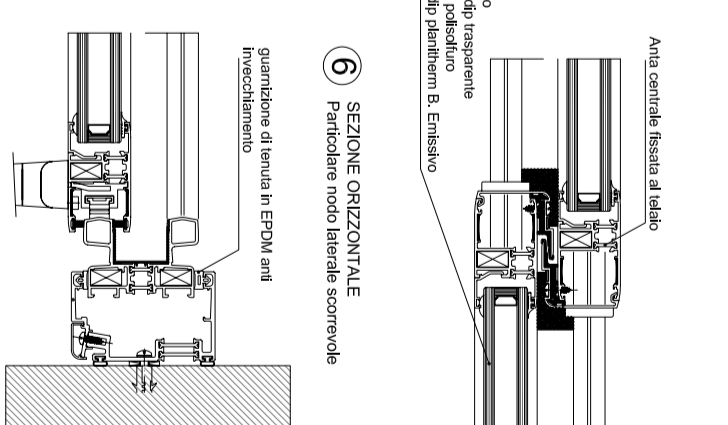

Prospetto tipologia T2

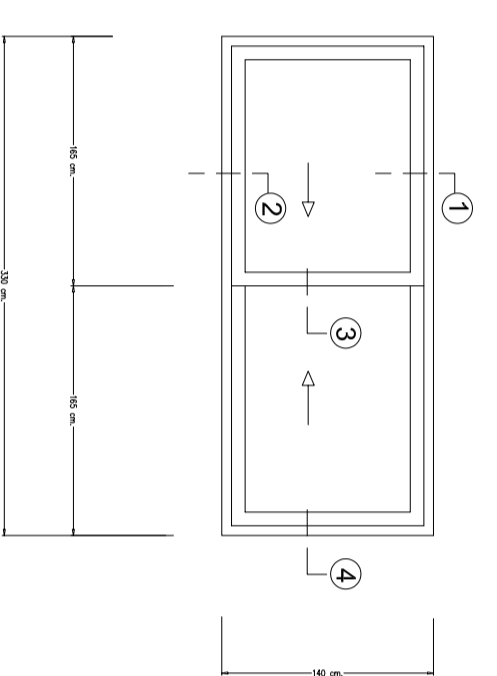

1 SEZIONE VERTICALE
Pannello con vista a mano sinistra

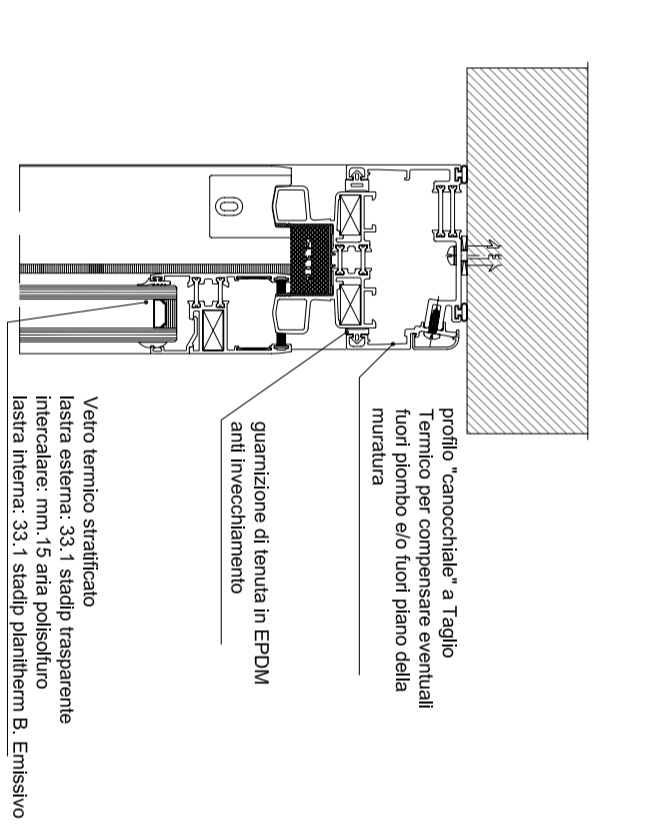

2 SEZIONE VERTICALE
Pannello con vista a mano destra

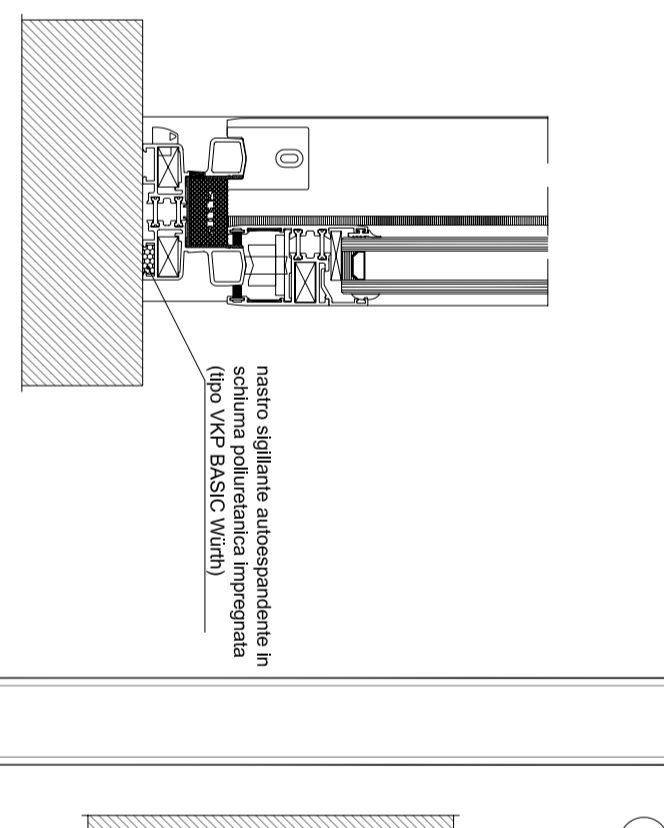

3 SEZIONE ORIZZONTALE
Pannello tipo "trasvolante"

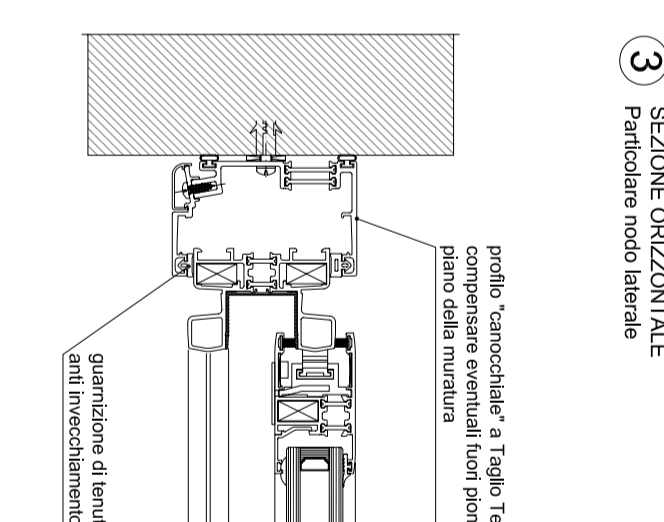

4 SEZIONE ORIZZONTALE
Pannello tipo "trasvolante"

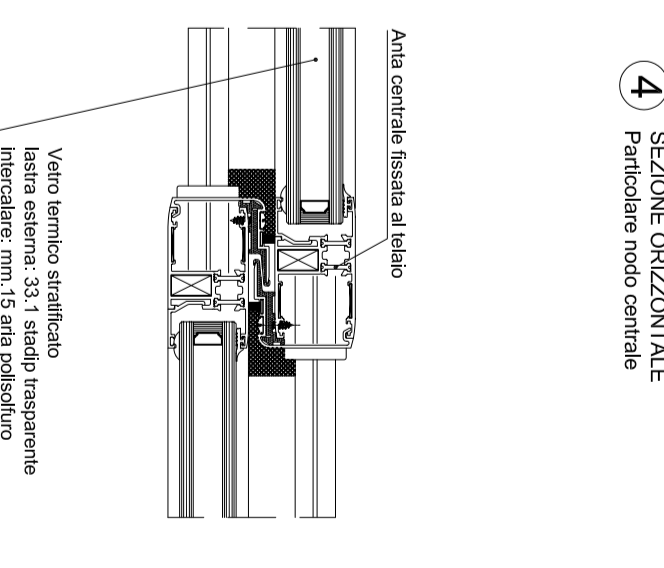

Prospetto tipologia T3

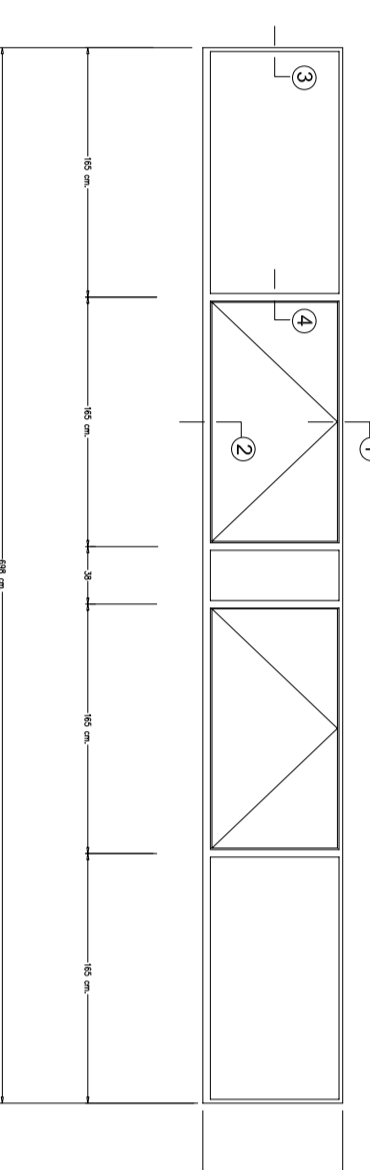

1 SEZIONE VERTICALE
Pannello con vista a mano sinistra

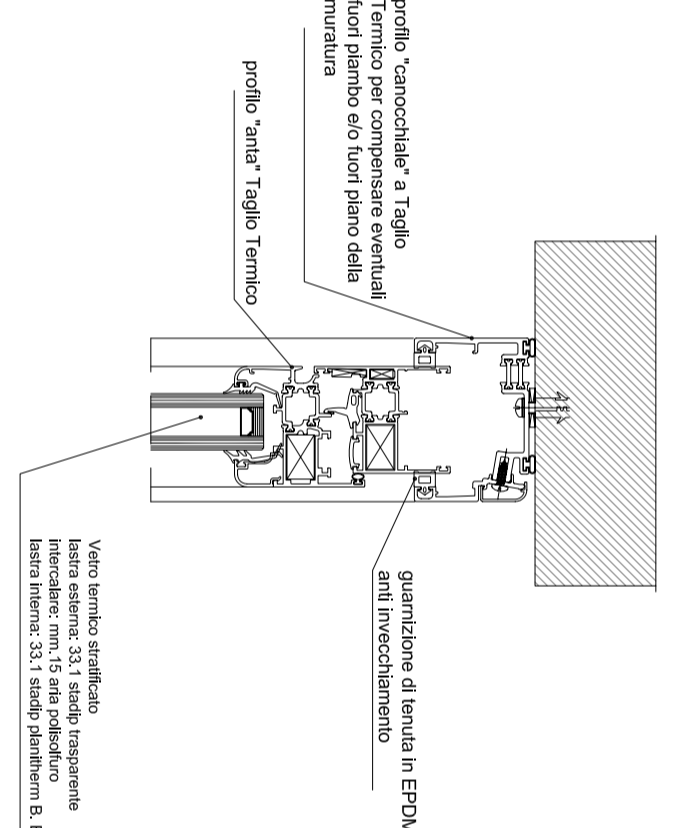

2 SEZIONE VERTICALE
Pannello tipo "trasvolante"

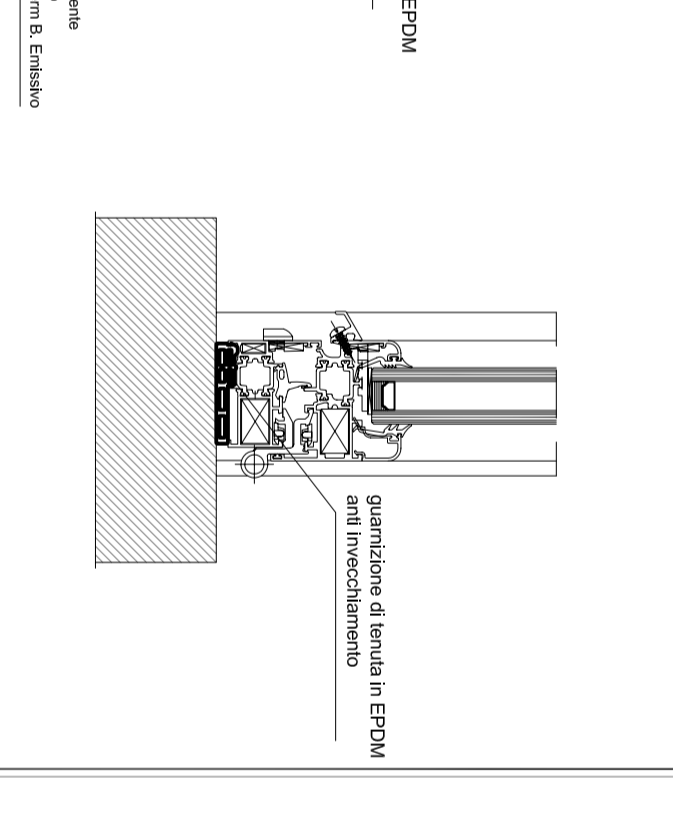

3 SEZIONE ORIZZONTALE
Pannello tipo "trasvolante"

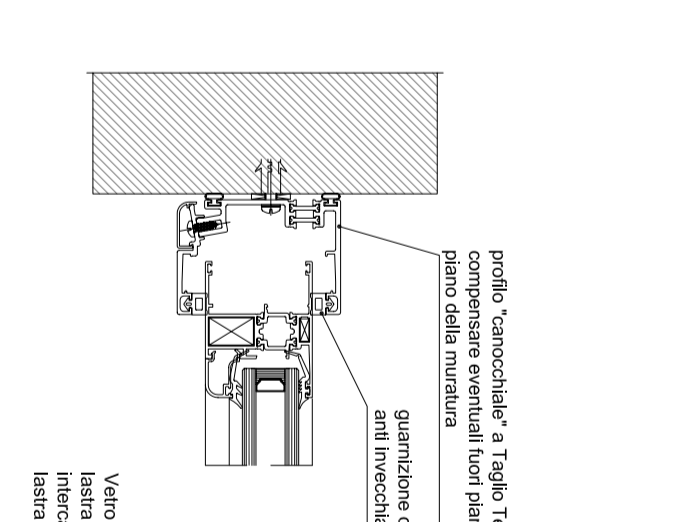

4 SEZIONE ORIZZONTALE
Pannello tipo "trasvolante"

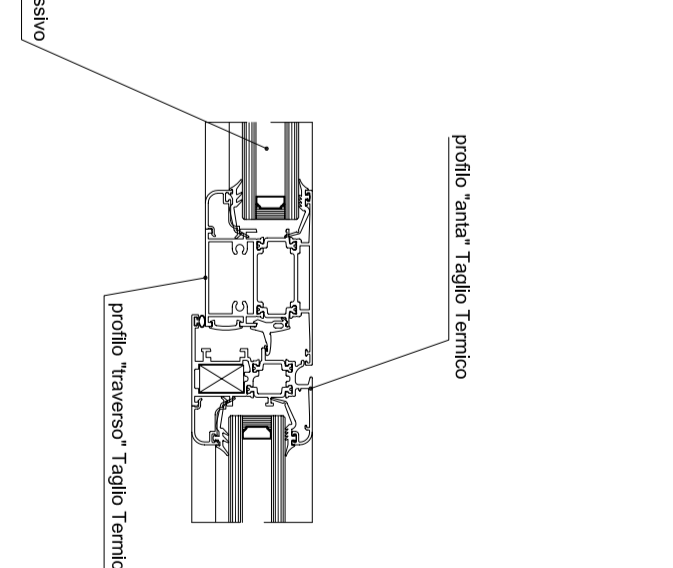

Prospetto tipologia T4
(vasistas)

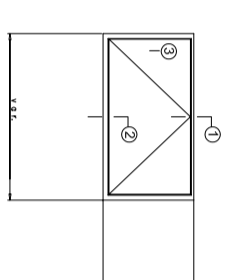

1 SEZIONE VERTICALE
Pannello con vista a mano sinistra

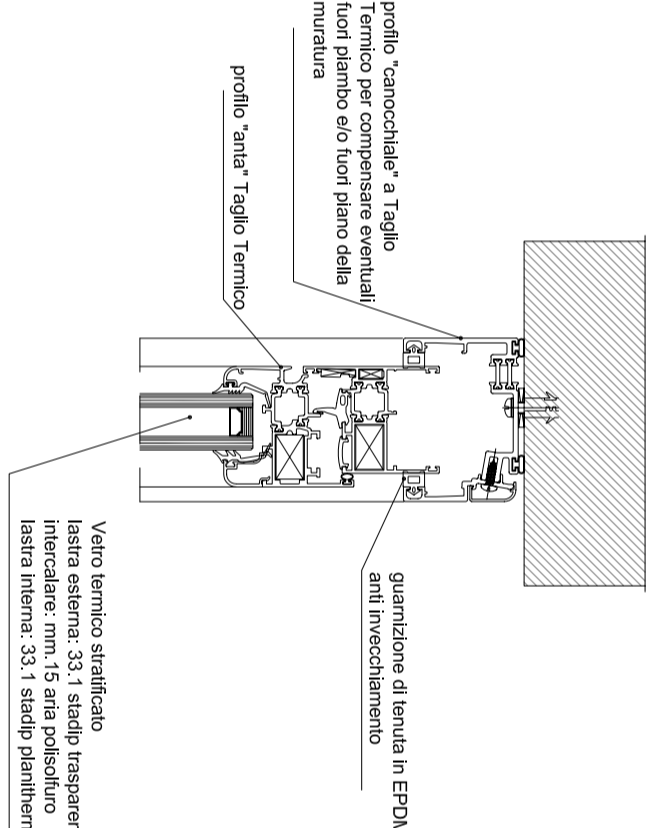

2 SEZIONE VERTICALE
Pannello tipo "trasvolante"

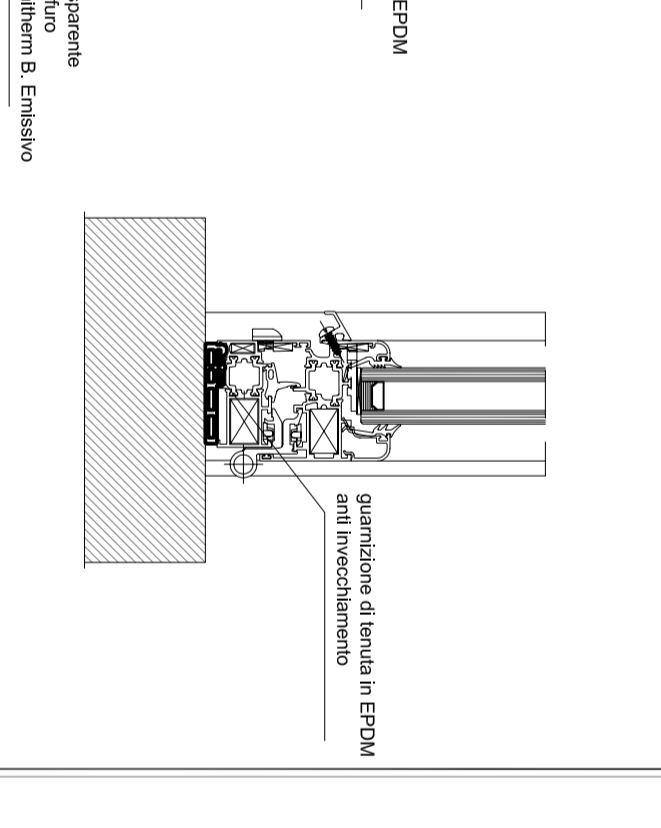

3 SEZIONE ORIZZONTALE
Pannello tipo "trasvolante"

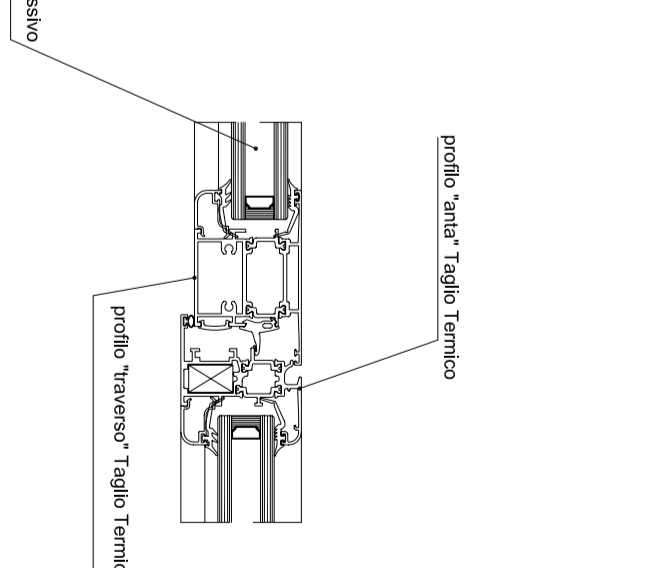

Prospetto tipologia T5
(vasistas)

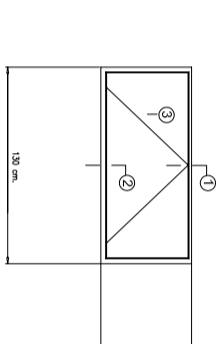

1 SEZIONE VERTICALE
Pannello con vista a mano sinistra

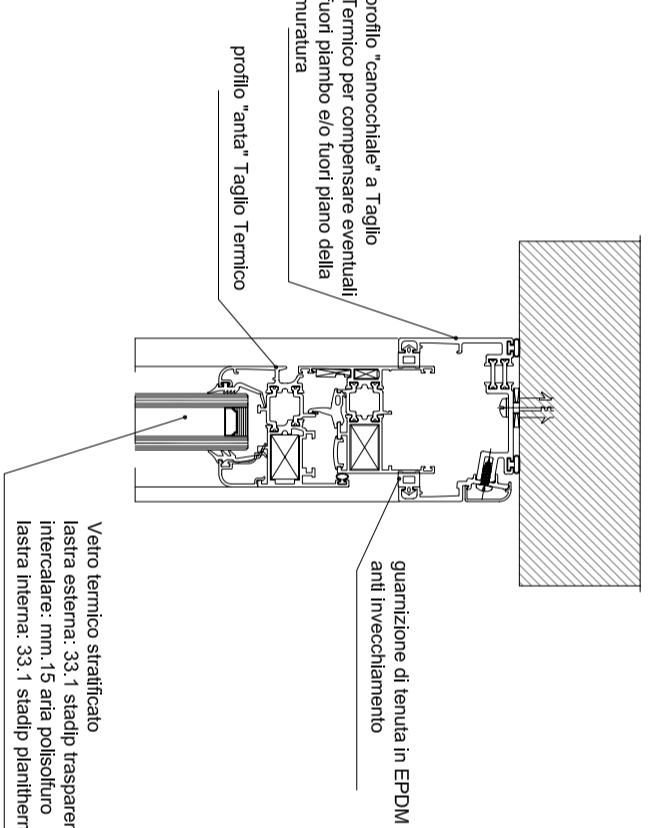

2 SEZIONE VERTICALE
Pannello tipo "trasvolante"

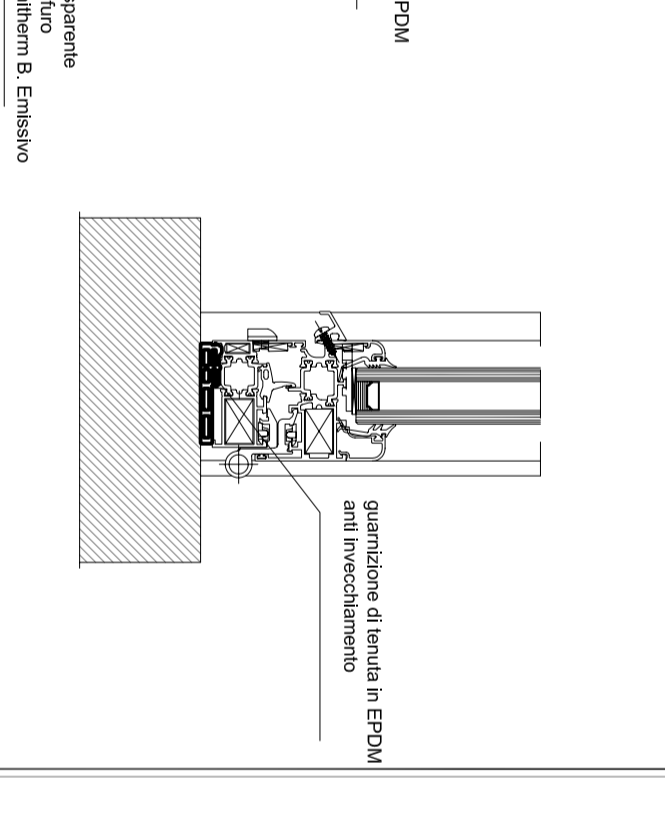

3 SEZIONE ORIZZONTALE
Pannello tipo "trasvolante"

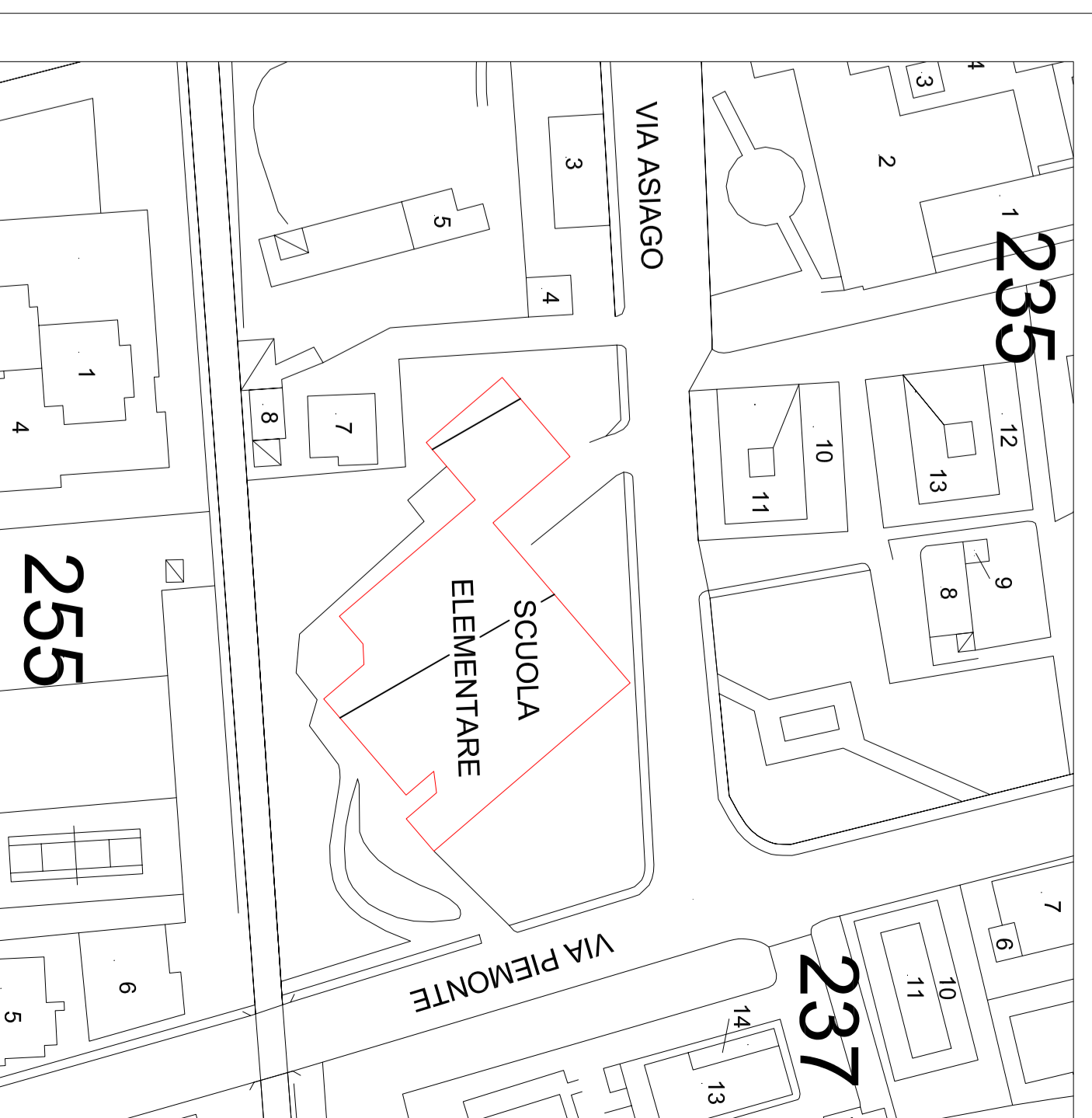
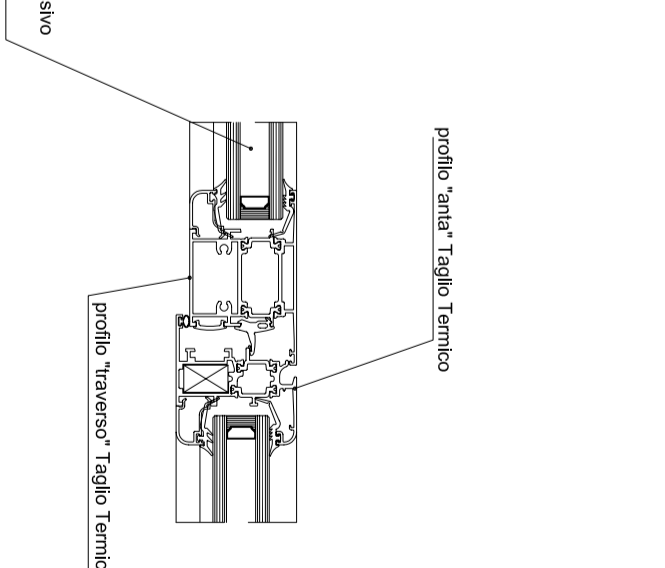

Città di S. Benedetto del Tronto
 P R O V I N C I A D I A S C O L I P I C E N O
 SETTORE MANUTENZIONE
 e QUALITÀ URBANA

**LAVORI DI:
 MANUTENZIONE STRAORDINARIA
 Infissi Scuola Elementare
 "Bice Piacentini"**

MANUTENZIONE DEI FIANCHI
13MS109

Aggiornamento
PROGETTO ESECUTIVO

Elaborato
B3a

Tipologie di infissi
Prospetti e sezioni

Scala 1:50

Progettati:
 Genia Filippa Formanini
 Genia Daniela Formanini
 Collaboratori:
 Genia Caterina Lanre

Il Responsabile Tecnico del Progettato:
 Dott. Vito Elio Russo

Il Disegnatore:
 Scienze Manutenzione e Qualità Urbana
 Dott. Ing. Maria Laravati